

# TECHNICAL DATA

## Electrical

Impedance 50 Ω  
 Frequency range 0~ 27 GHz  
 VSWR 1.10:1 (0~18GHz)  
 1.15:1 (18GHz~27GHz)

Contact resistance  
 -centre contact ≤3mΩ  
 -outer contact ≤2mΩ  
 Insulation resistance ≥5000MΩ

## Mechanical & Environmental

Durability (matings) >500  
 Temperature range -55 °C ~ +165 °C  
 RoHS Compliant Yes

## Material & Finish

Body Stainless Steel (SU303), Passivated  
 Pin Contact Beryllium Copper Alloy, Gold-plated  
 Insulator PTFE & PEI

## Interface Standards

SMA MIL-STD-348A

REVISIONS				
REV	DESCRIPTION OF REVISION	ECN No.	DATE	APPROVED
A	INITIAL RELEASE	---	03/01/2011	M. Dong
B	ADD TYPE "F"	---	12/17/2016	M. Dong

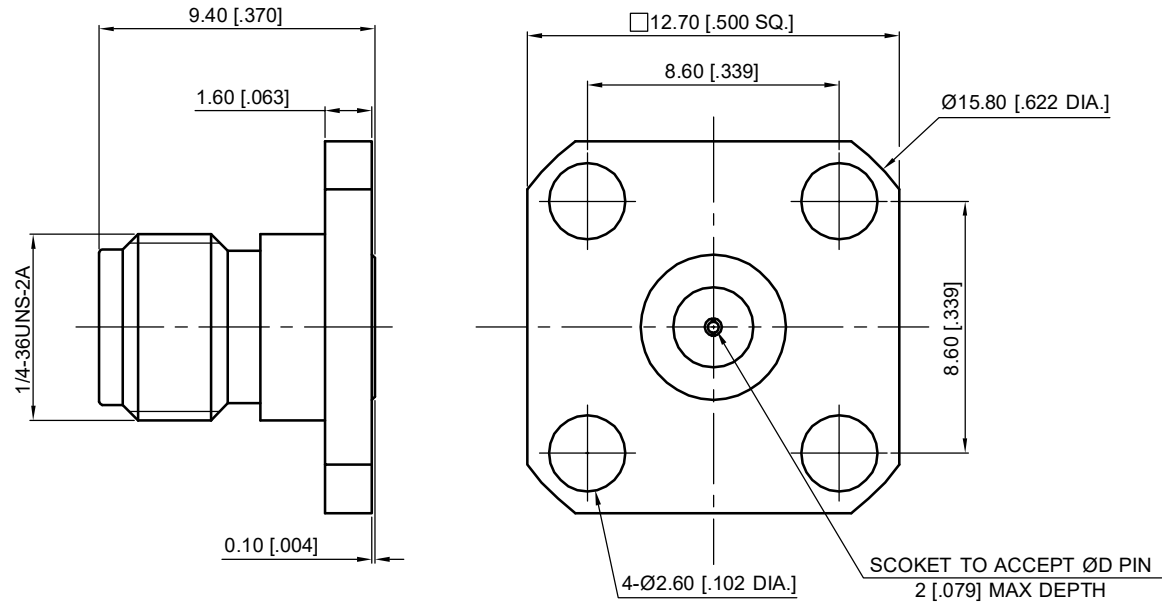

Part Number	ØD PIN
60-02-9F5-074A	0.23 [.009]
60-02-9F5-074B	0.30 [.012]
60-02-9F5-074C	0.38 [.015]
60-02-9F5-074D	0.46 [.018]
60-02-9F5-074E	0.51 [.020]
60-02-9F5-074F	0.91 [.036]

### NOTES:

- ALL SPECIFICATIONS ARE SUBJECT TO CHANGE WITHOUT NOTICE AT ANY TIME
- UNLESS OTHERWISE SPECIFIED ALL DIMENSIONS ARE NOMINAL.

UNLESS OTHERWISE SPECIFIED, DIMENSIONS ARE IN MILLIMETERS (INCHES).  
 UNLESS OTHERWISE SPECIFIED DIMENSIONAL TOLERANCES ARE:

.XX ±0.13 [.005]  
 .X ±0.20 [.008]  
 X ±0.50 [.019]

ANGULAR TOLERANCES ARE: ALL= ±1°

DO NOT SCALE DRAWING

PROJECTION:

DRAWN:	L. Ma	12/17/2016
CHECKED:	J. Zhu	12/17/2016
APPROVED:	M. Dong	12/17/2016

TITLE:  
**SMA Straight Female,  
 4 Hole Flange, Accept Pin**



Cmppter Electronics Co., Ltd. [www.cmppter.com](http://www.cmppter.com)

PART No.:  
**60-02-9F5-074**

SIZE: A4	SCALE: 4:1	SHEET: 1/1	REV: B
-------------	---------------	---------------	-----------