

A B C D E F G H I J

REVISIONS				
REV	DESCRIPTION OF REVISION	ECN No.	DATE	APPROVED
A	INITIAL RELEASE	—	07/26/2018	M. Dong

TECHNICAL DATA

Electrical

Impedance 50 Ω
 Frequency range 0–6 GHz
 Withstanding voltage 750 V
 Insulation resistance $\geq 5 \times 10^3$ MΩ

Mechanical & Environmental

Durability (matings) >500
 Temperature range -55 °C ~ +165 °C
 RoHS Compliant Yes

Material & Finish

Body Brass, Gold-plated
 Pin Contact Brass, Gold-plated
 Coupling Nut Brass, Gold-plated
 Insulator PTFE

Interface Standards

SMA IEC-60169

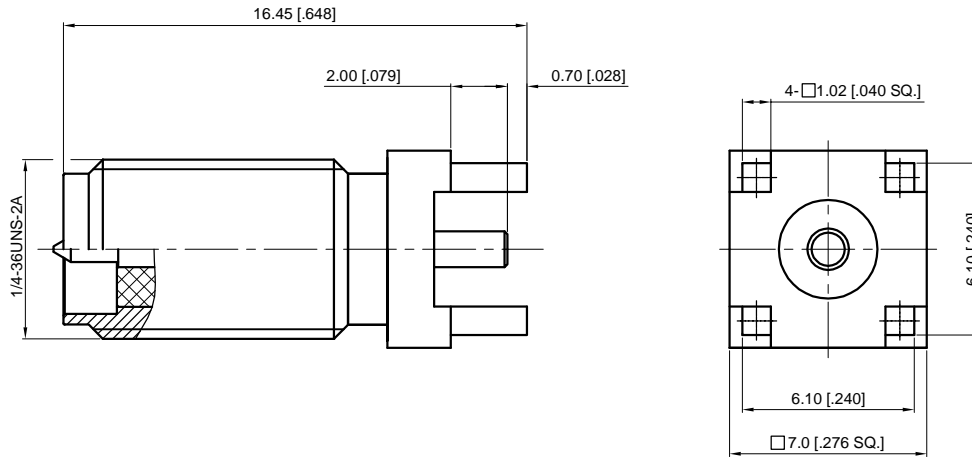

1
2
3
4
5
6
7

1
2
3
4
5
6
7

NOTES:

- ALL SPECIFICATIONS ARE SUBJECT TO CHANGE WITHOUT NOTICE AT ANY TIME
- UNLESS OTHERWISE SPECIFIED ALL DIMENSIONS ARE NOMINAL.

UNLESS OTHERWISE SPECIFIED, DIMENSIONS ARE IN MILLIMETERS (INCHES).
 UNLESS OTHERWISE SPECIFIED DIMENSIONAL TOLERANCES ARE:
 .XX ±0.13 [0.005"]
 X ±0.20 [0.008"]
 X ±0.50 [0.019"]

ANGULAR TOLERANCES ARE: ALL ±1°

DO NOT SCALE DRAWING

PROJECTION:

DRAWN:	L. Ma	07/26/2018
CHECKED:	J. Zhu	07/26/2018
APPROVED:	M. Dong	07/26/2018

TITLE:
RP SMA Straight Female for PCB Board



Cmppter Electronics Co., Ltd. www.cmppter.com

PART No.:
61-02-5L2-049

SIZE: A4	SCALE: 5:1	SHEET: 1/1	REV: A
-------------	---------------	---------------	-----------

A B C D E F G H I J