

TECHNICAL DATA

Electrical

Impedance 50 Ω
 Frequency range 0~67 GHz
 VSWR ≤1.35

Mechanical & Environmental

Durability (matings) >500
 Temperature range -55 °C ~ +165 °C
 RoHS Compliant Yes

Material & Finish

Body Stainless Steel (SU303), Passivated
 Pin Contact Beryllium Copper Alloy, Gold-plated
 Insulator PEI

Interface Standards

1.85mm IEC-61169

REVISIONS				
REV	DESCRIPTION OF REVISION	ECN No.	DATE	APPROVED
A	INITIAL RELEASE	---	08/17/2020	M. Dong
B	STRUCTURE CHANGED	---	04/02/2021	M. Dong

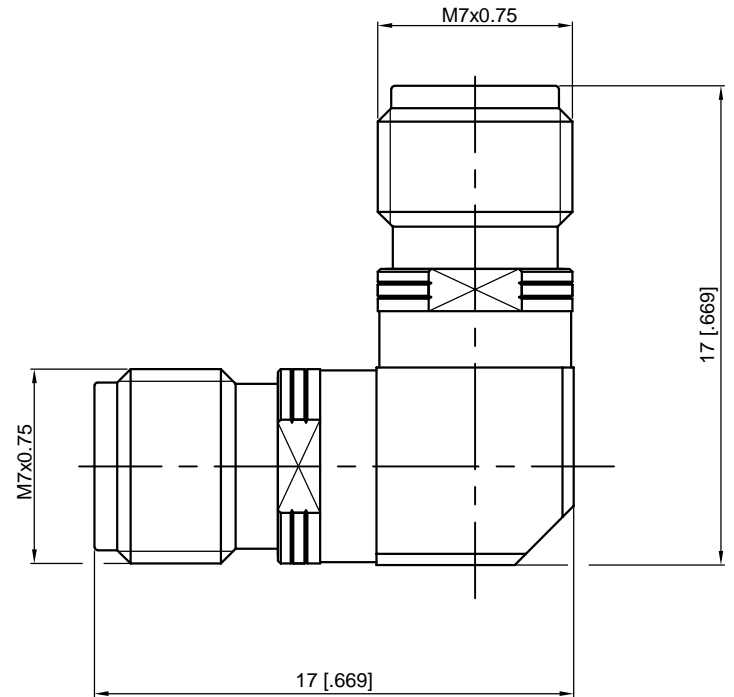

1
2
3
4
5
6
7

1
2
3
4
5
6
7

- NOTES:
1. ALL SPECIFICATIONS ARE SUBJECT TO CHANGE WITHOUT NOTICE AT ANY TIME
 2. UNLESS OTHERWISE SPECIFIED ALL DIMENSIONS ARE NOMINAL.

UNLESS OTHERWISE SPECIFIED, DIMENSIONS ARE IN MILLIMETERS (INCHES). UNLESS OTHERWISE SPECIFIED DIMENSIONAL TOLERANCES ARE: .XX ±0.13 [.005"] X ±0.20 [.008"] X ±0.50 [.019"] ANGULAR TOLERANCES ARE: ALL±1° DO NOT SCALE DRAWING PROJECTION:	DRAWN:	W. Shen	04/02/2021
	CHECKED:	K. Liu	04/02/2021
	APPROVED:	M. Dong	04/02/2021
	TITLE:	Precision Adapter, Right Angle, 1.85mm Female to 1.85mm Female	

CMPPTER®
 Cmppter Electronics Co., Ltd. www.cmppter.com

PART No.: **PR-1.85F-1.85F-442**

SIZE: A4	SCALE: 4:1	SHEET: 1/1	REV: B
----------	------------	------------	--------