

TECHNICAL DATA

Electrical

Impedance 50 Ω
 Frequency range 0~18 GHz
 VSWR 1.15:1
 Average Power 1W

Mechanical & Environmental

Durability (matings) >500
 Temperature range -55 °C ~ +125 °C
 RoHS Compliant Yes

Material & Finish

Body Stainless Steel (SU303), Passivated
 Pin Contact Beryllium Copper Alloy, Gold-plated
 Coupling nut Stainless Steel (SU303), Passivated

Interface Standards

SMA MIL-STD-348A

REVISIONS				
REV	DESCRIPTION OF REVISION	ECN No.	DATE	APPROVED
A	INITIAL RELEASE	—	08/02/2010	M. Dong

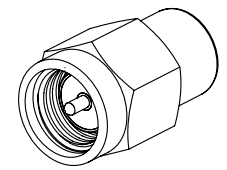
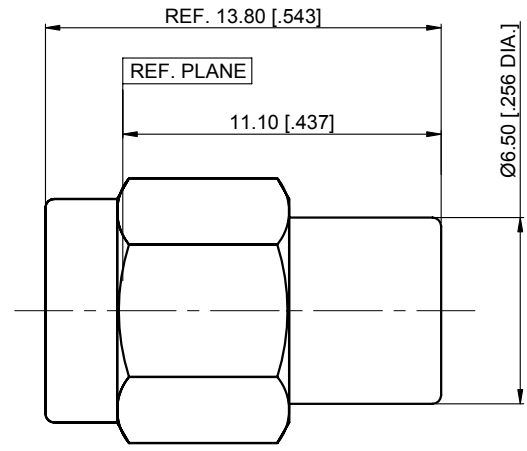

UNLESS OTHERWISE SPECIFIED, DIMENSIONS ARE IN MILLIMETERS (INCHES). UNLESS OTHERWISE SPECIFIED DIMENSIONAL TOLERANCES ARE: .XX ±0.13 [.005"] .X ±0.20 [.008"] X ±0.50 [.019"]
ANGULAR TOLERANCES ARE: ALL±1°
DO NOT SCALE DRAWING
PROJECTION:

DRAWN:	L. Ma	08/02/2010
CHECKED:	J. Zhu	08/02/2010
APPROVED:	M. Dong	08/02/2010

TITLE:
Precision SMA Male Termination, 1W, 18GHz

 Cmpter Electronics Co., Ltd. www.cmpter.com			
PART No.: TP-SMAM-003			
SIZE: A4	SCALE: 4:1	SHEET: 1/1	REV: A

1
2
3
4
5
6
7

1
2
3
4
5
6
7

- NOTES:
- ALL SPECIFICATIONS ARE SUBJECT TO CHANGE WITHOUT NOTICE AT ANY TIME
 - UNLESS OTHERWISE SPECIFIED ALL DIMENSIONS ARE NOMINAL.