

TECHNICAL DATA

Electrical
 Impedance 50 Ω
 Frequency range 0~18 GHz
 VSWR 1.15:1
 Average Power 1W

Mechanical & Environmental
 Durability (matings) >500
 Temperature range -55 °C ~ +125 °C
 RoHS Compliant Yes

Material & Finish
 Body Stainless Steel (SU303), Passivated
 Pin Contact Beryllium Copper Alloy, Gold-plated
 Coupling nut Stainless Steel (SU303), Passivated

Interface Standards
 SMA MIL-STD-348A

REVISIONS				
REV	DESCRIPTION OF REVISION	ECN No.	DATE	APPROVED
A	INITIAL RELEASE	—	08/02/2010	M. Dong

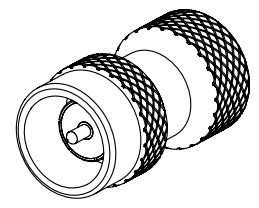
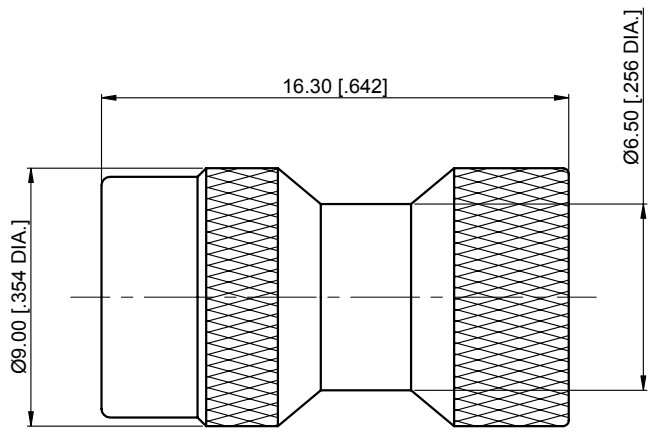

- NOTES:**
- ALL SPECIFICATIONS ARE SUBJECT TO CHANGE WITHOUT NOTICE AT ANY TIME
 - UNLESS OTHERWISE SPECIFIED ALL DIMENSIONS ARE NOMINAL.

UNLESS OTHERWISE SPECIFIED, DIMENSIONS ARE IN MILLIMETERS [INCHES]. UNLESS OTHERWISE SPECIFIED DIMENSIONAL TOLERANCES ARE: .XX ±0.13 [.005"] .X ±0.20 [.008"] X ±0.50 [.019"] ANGULAR TOLERANCES ARE: ALL±1° DO NOT SCALE DRAWING PROJECTION:	DRAWN:	L. Ma	08/02/2010	Cmppter Electronics Co., Ltd. www.cmppter.com	
	CHECKED:	J. Zhu	08/02/2010		
	APPROVED:	M. Dong	08/02/2010		
TITLE:		Precision SMA Male Quick Mate Termination, 1W, 18GHz		PART No.:	TP-SMAM-011
		SIZE:	A4	SCALE:	4:1
		SHEET:	1/1	REV:	A