

REVISIONS				
REV	DESCRIPTION OF REVISION	ECN No.	DATE	APPROVED
A	INITIAL RELEASE	—	15/03/12	M. Dong

## TECHNICAL DATA

### Electrical

RF Connector Impedance 50 Ω  
 Frequency range 26.5 to 40 GHz  
 VSWR 1.25 Max.

### Mechanical & Environmental

Waveguide Interface WR-28  
 RF Connector Interface 2.92mm Female  
 Durability (matings) >500  
 Temperature range -55 °C ~ +125 °C  
 RoHS Compliant Yes

### Material & Finish

Waveguide Body Brass, Gold-plated  
 RF Connector Body Stainless Steel (SU303), Passivated

### Interface Standards

2.92mm MIL-STD-348A

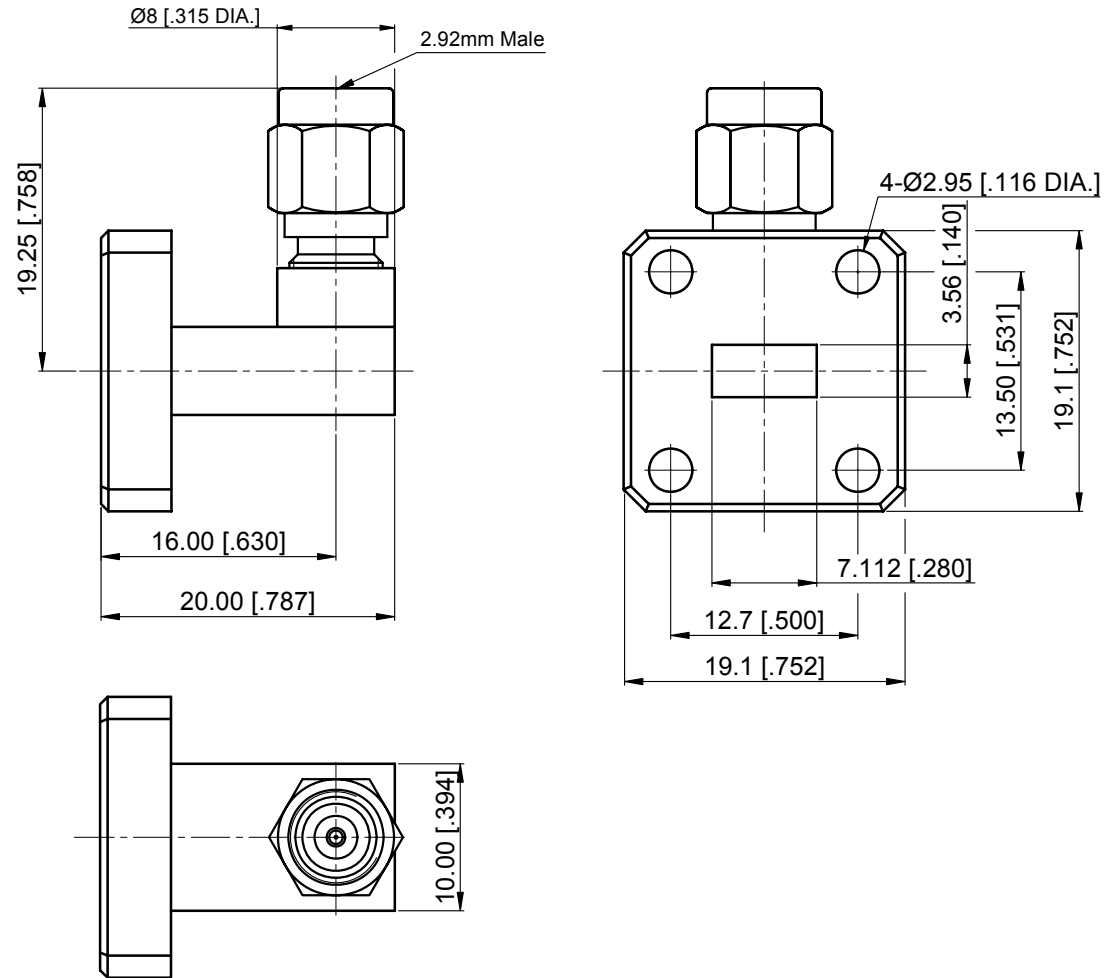

### NOTES:

- ALL SPECIFICATIONS ARE SUBJECT TO CHANGE WITHOUT NOTICE AT ANY TIME
- UNLESS OTHERWISE SPECIFIED ALL DIMENSIONS ARE NOMINAL.

DRAWN:	W. Shen	15/03/12
CHECKED:	K. Liu	15/03/12
APPROVED:	M. Dong	15/03/12

UNLESS OTHERWISE SPECIFIED, DIMENSIONS ARE IN MILLIMETERS (INCHES).  
 UNLESS OTHERWISE SPECIFIED DIMENSIONAL TOLERANCES ARE:

.XX	±0.13 [.005"]
.X	±0.20 [.008"]
X	±0.50 [.019"]

ANGULAR TOLERANCES ARE: ALL=±1°

TITLE:

WR-28 With Square Cover Flange  
 to 2.92mm Male Waveguide to  
 Coax Adapter Operating From 26.5  
 GHz to 40 GHz

DO NOT SCALE  
 DRAWING

PROJECTION:



PART No.:

WCA-WR28-2.92M-002

SIZE:  
A4

SCALE:  
4:1

SHEET:  
1/1

REV:  
A