

REV	DESCRIPTION OF REVISION	ECN No.	BY	DATE	APPROVED
A	INITIAL RELEASE		L. Ma	06/21/10	06/21/10

TECHNICAL DATA

Electrical data

Impedance	50 Ω
Frequency range	0~27 GHz
VSWR	1.15:1

Mechanical data

Temperature range	-55 °C ~ +165 °C
Durability (matings)	>500

Material data

Body	Stainless Steel (SU303), Passivated
Pin Contact	Beryllium Copper Alloy, Gold-plated
Insulator	PEI, PTFE

Interface Standards

SMA	MIL-STD-348A
-----	--------------

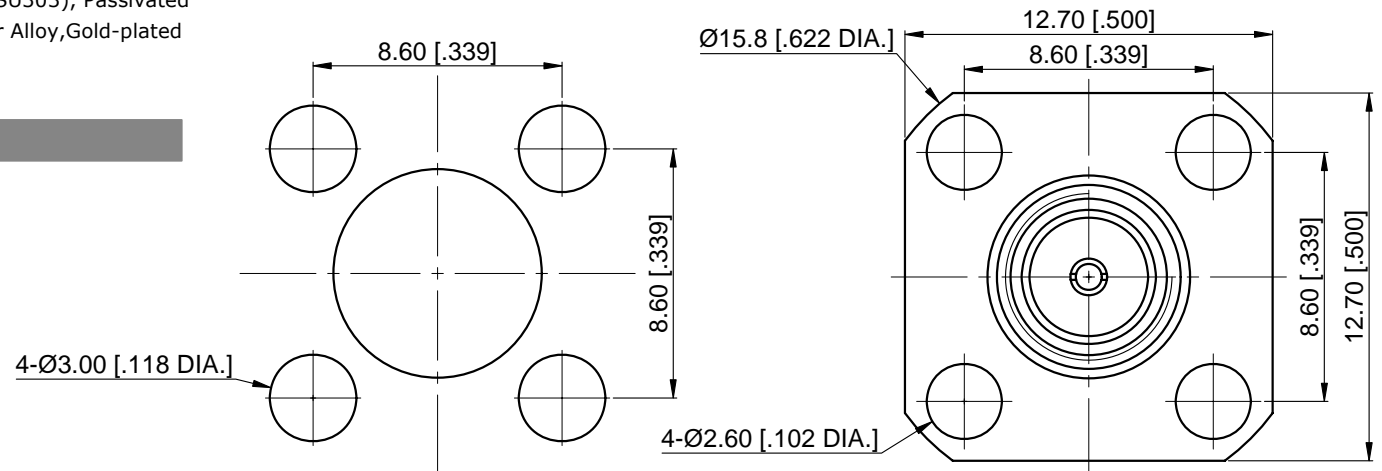
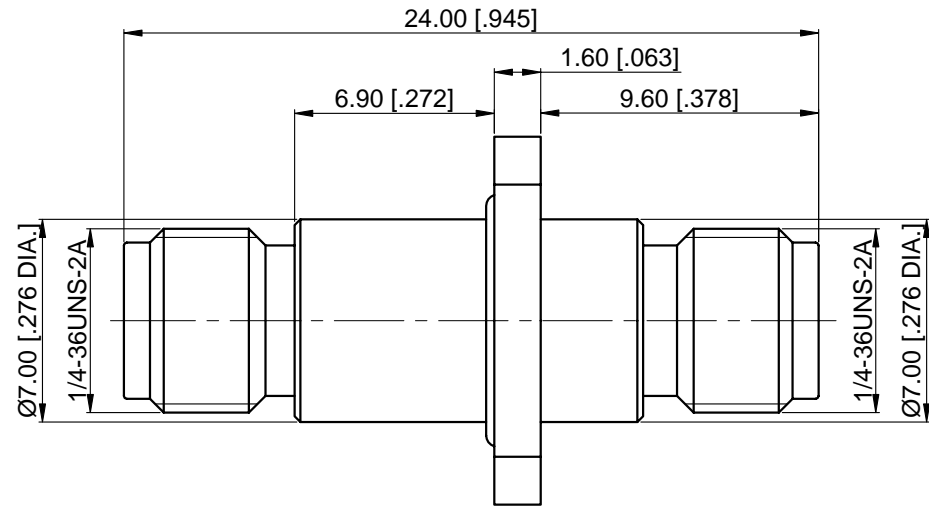

Recommended Mounting Hole

NOTES:

1. ALL SPECIFICATIONS ARE SUBJECT TO CHANGE WITHOUT NOTICE AT ANY TIME
2. CUSTOMER OUTLINE DRAWING FOR REFERENCE ONLY

DRAWN:	L. Ma 06/21/10
ENGINEER:	J. Zhu 06/21/10
APPROVED:	M. Dong 06/21/10
TOLERANCE UNLESS OTHERWISE SPECIFIED	
X	±0.50 [.019"]
.X	±0.20 [.008"]
.XX	±0.10 [.004"]
ANGLES	±1°

TITLE:

Precision Adapter, SMA
Female to SMA Female,
4 Hole Flange

PART No.: P-SMAF-SMAF-184

CMPPTER®

www.cmppter.com



DIMENSIONS IN MILLIMETERS (mm)

SIZE:	SCALE:	SHEET:	REV:
A4	5:1	1/1	A