

TECHNICAL DATA

Electrical

Impedance 50 Ω
 Frequency range 0~3 GHz
 Withstanding voltage 750V
 Insulation resistance ≥5000MΩ

Mechanical & Environmental

Durability (matings) >500
 Temperature range -55 °C ~ +165 °C
 RoHS Compliant Yes

Material & Finish

Body Brass, Gold-plated
 Pin Contact Phosphor Bronze, Gold-plated
 Insulator PTFE

Interface Standards

SMB IEC-60169

REVISIONS				
REV	DESCRIPTION OF REVISION	ECN No.	DATE	APPROVED
A	INITIAL RELEASE	—	07/28/2020	M. Dong

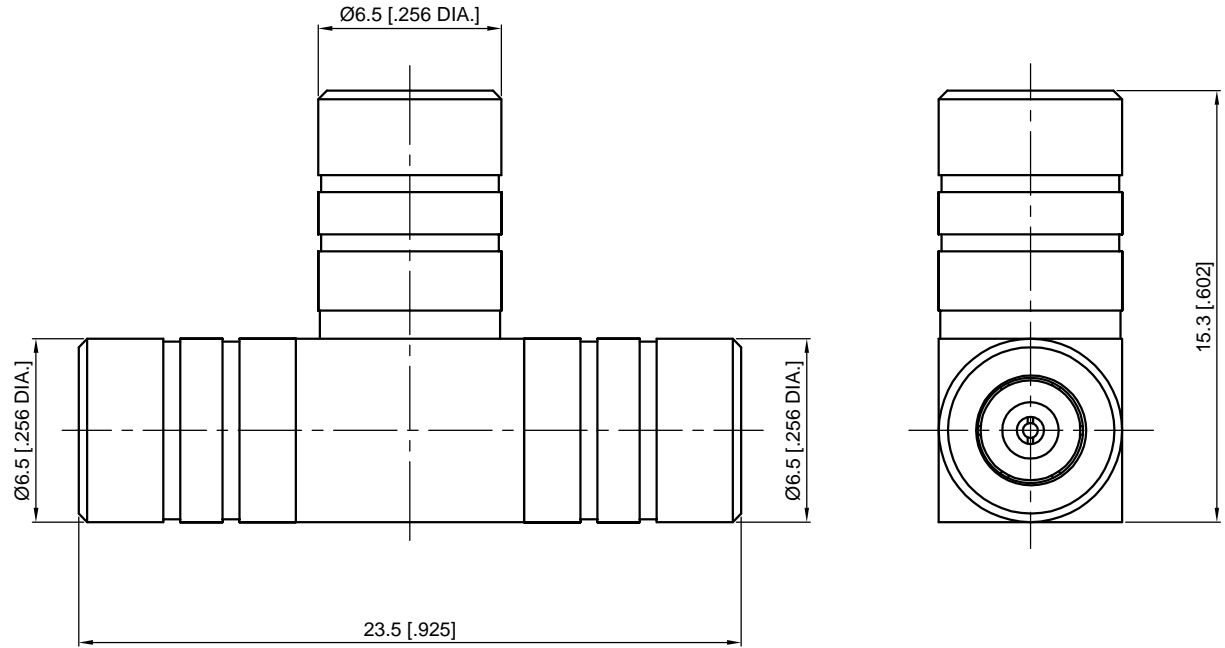

UNLESS OTHERWISE SPECIFIED, DIMENSIONS ARE IN MILLIMETERS (INCHES). UNLESS OTHERWISE SPECIFIED DIMENSIONAL TOLERANCES ARE: .XX ±0.13 [.005] X ±0.20 [.008] X ±0.50 [.019] ANGULAR TOLERANCES ARE: ALL= ±1°	DRAWN: L. Ma 07/28/2020
DO NOT SCALE DRAWING	CHECKED: J. Zhu 07/28/2020
PROJECTION:	APPROVED: M. Dong 07/28/2020

TITLE: Tee Adapter, SMB Plug (Female Center Contact)-Plug (Female Center Contact)-Plug (Female Center Contact)		
--	--	--

CMP TER[®]
 Cmpter Electronics Co., Ltd. www.cmpter.com

PART No.:
A-SMBM-SMBM-SMBM-399

SIZE: A4	SCALE: 4:1	SHEET: 1/1	REV: A
----------	------------	------------	--------

- NOTES:
- ALL SPECIFICATIONS ARE SUBJECT TO CHANGE WITHOUT NOTICE AT ANY TIME
 - UNLESS OTHERWISE SPECIFIED ALL DIMENSIONS ARE NOMINAL.