

TECHNICAL DATA

Electrical

Impedance 50 Ω
 Frequency range 0~6 GHz
 Voltage Rating 250 V rms
 Insulation resistance ≥1000MΩ

Mechanical & Environmental

Durability (matings) >500
 Temperature range -55 °C ~ +165 °C
 RoHS Compliant Yes

Material & Finish

Body Brass, Gold-plated
 Pin Contact Brass, Gold-plated
 Outer Contact Phosphor Bronze, Gold-plated
 Insulator PTFE

Interface Standards

MCX IEC-61169

REVISIONS				
REV	DESCRIPTION OF REVISION	ECN No.	DATE	APPROVED
A	INITIAL RELEASE	---	03/11/2007	M. Dong
B	DIMENSION CHANGED	---	08/09/2013	M. Dong
C	DIMENSION CHANGED	---	04/18/2018	M. Dong

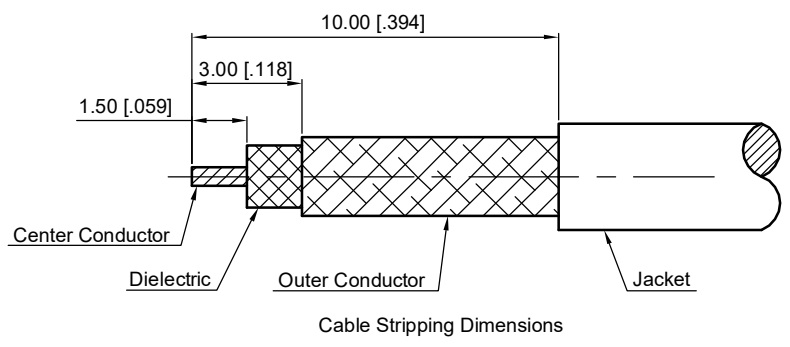
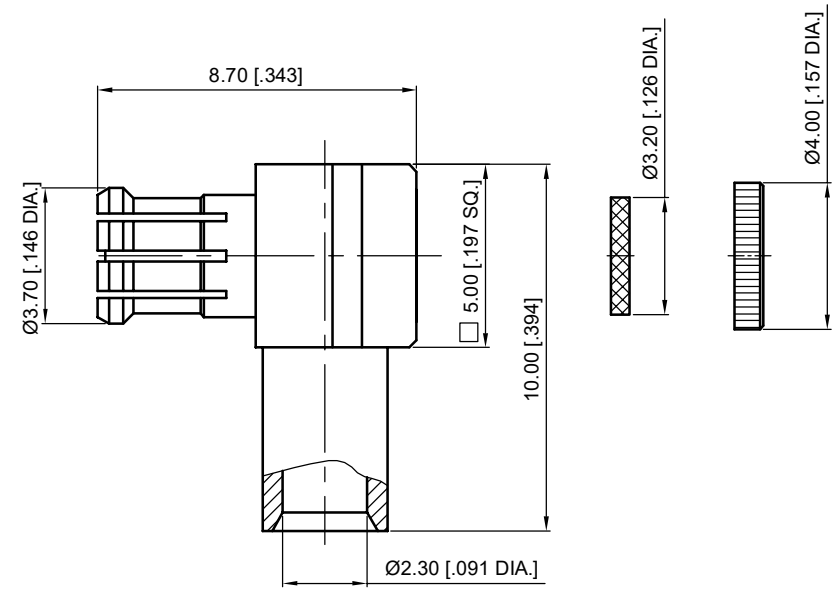

1
2
3
4
5
6
7

1
2
3
4
5
6
7

NOTES:
 1. ALL SPECIFICATIONS ARE SUBJECT TO CHANGE WITHOUT NOTICE AT ANY TIME
 2. UNLESS OTHERWISE SPECIFIED ALL DIMENSIONS ARE NOMINAL.

UNLESS OTHERWISE SPECIFIED, DIMENSIONS ARE IN MILLIMETERS (INCHES).
 UNLESS OTHERWISE SPECIFIED DIMENSIONAL TOLERANCES ARE:

.XX	±0.13 [.005"]
.X	±0.20 [.008"]
X	±0.50 [.019"]

ANGULAR TOLERANCES ARE: ALL= ±1°

DO NOT SCALE DRAWING

PROJECTION:

DRAWN:	L. Ma	04/18/2018
CHECKED:	J. Zhu	04/18/2018
APPROVED:	M. Dong	04/18/2018

TITLE:
MCX Right Angle Male
Solder for .086/RG405 Cable

CMP TER®
 Cmpter Electronics Co., Ltd. www.cmpter.com

PART No.:
30-13-2M11-009

SIZE: A4	SCALE: 5:1	SHEET: 1/1	REV: C
----------	------------	------------	--------

A B C D E F G H I J