

# TECHNICAL DATA

## Electrical

Impedance 50 Ω  
 Frequency range 0~ 8 GHz  
 Withstanding voltage 1000 V  
 Insulation resistance ≥5000MΩ

## Mechanical & Environmental

Durability (matings) >500  
 Temperature range -55 °C ~ +165 °C  
 RoHS Compliant Yes

## Material & Finish

Body Brass, Nickel-plated  
 Pin Contact Phosphor Bronze, Gold-plated  
 Snap Ring Steel  
 Insulator PTFE

## Interface Standards

N IEC-60169

REVISIONS				
REV	DESCRIPTION OF REVISION	ECN No.	DATE	APPROVED
A	INITIAL RELEASE	---	04/06/2018	M. Dong
B	STRUCTURE CHANGED	---	07/24/2018	M. Dong
C	ADD INSULATOR	---	12/17/2018	M. Dong

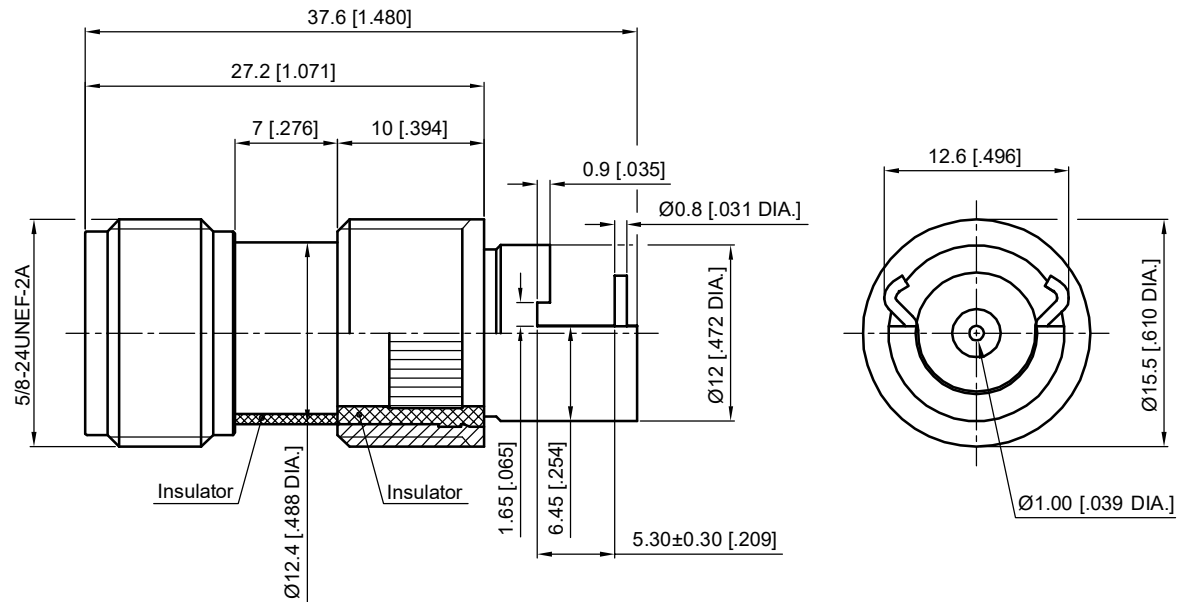

UNLESS OTHERWISE SPECIFIED, DIMENSIONS ARE IN MILLIMETERS [INCHES].  
 UNLESS OTHERWISE SPECIFIED DIMENSIONAL TOLERANCES ARE:

.XX ±0.13 [.005\*]  
 X ±0.20 [.008\*]  
 X ±0.50 [.019\*]

ANGULAR TOLERANCES ARE: ALL= ±1°

DO NOT SCALE DRAWING

PROJECTION:

DRAWN:	L. Ma	12/17/2018
CHECKED:	J. Zhu	12/17/2018
APPROVED:	M. Dong	12/17/2018

TITLE:  
**N Straight Female for PCB Board**



Cmpter Electronics Co., Ltd. [www.cmpter.com](http://www.cmpter.com)

PART No.:  
**50-02-5L2-202**

SIZE: A4	SCALE: 2:1	SHEET: 1/1	REV: C
----------	------------	------------	--------

- NOTES:
- ALL SPECIFICATIONS ARE SUBJECT TO CHANGE WITHOUT NOTICE AT ANY TIME
  - UNLESS OTHERWISE SPECIFIED ALL DIMENSIONS ARE NOMINAL.