

REV	DESCRIPTION OF REVISION	ECN No.	BY	DATE	APPROVED
A	INITIAL RELEASE	—	L. Ma	09/08/08	M. Dong
B	STRUCTURE CHANGED	—	L. Ma	03/14/09	M. Dong

TECHNICAL DATA

Electrical data

Impedance	50 Ω
Frequency range	0~6 GHz
Insulation resistance	$\geq 5 \times 10^3 M\Omega$
Withstanding voltage	1000 V

Mechanical data

Temperature range	-65 °C ~ +165 °C
Durability (matings)	>500

Material data

Bodies	Brass, See Schedule
Pin Contact	Bass, Gold-plated
Fastening Nut	Brass, See Schedule
Crimp Ferrule	Copper, Nickel-plated
Insulator	PTFE
Washer	Beryllium Copper Alloy, Gold-plated

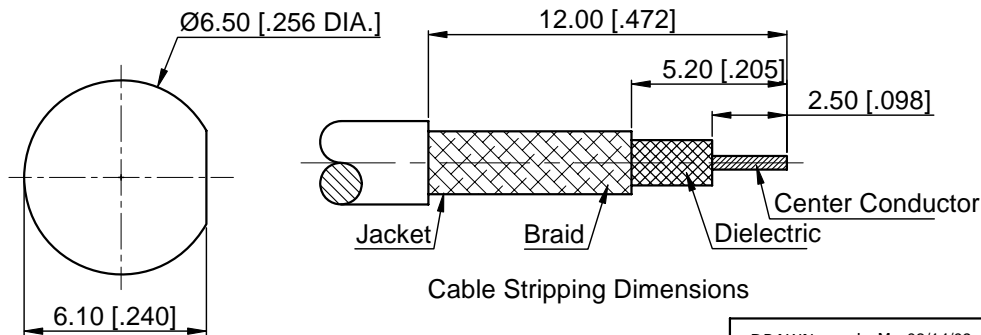
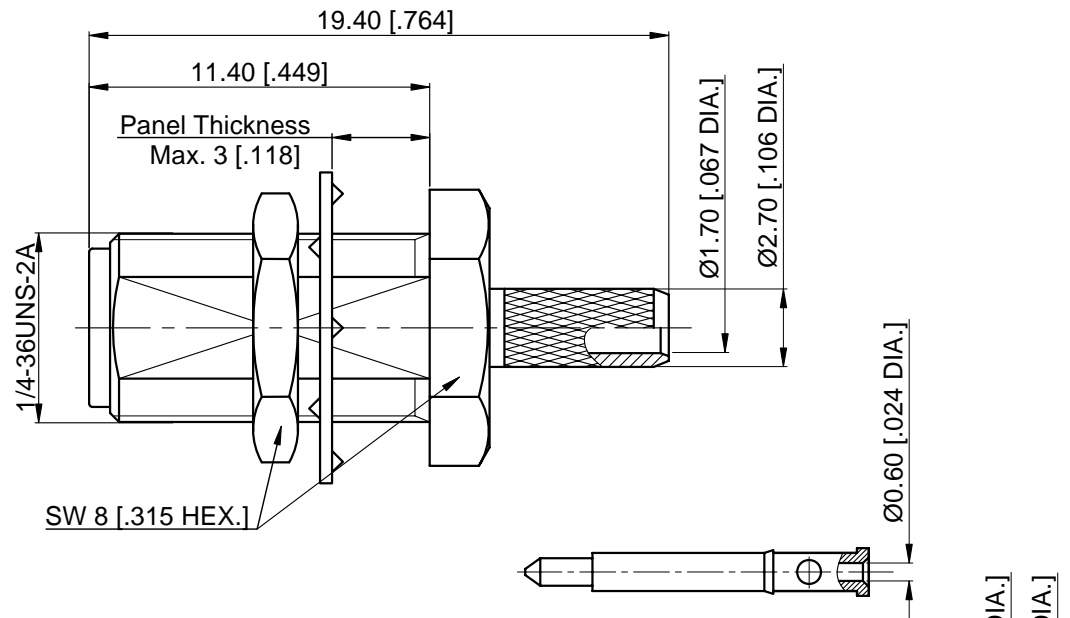

Part Number	Part / Finish
61-02-1B00-001-1	Bodies / Gold
	Fastening Nut / Gold
	Washer / Gold
61-02-1B00-001-2	Bodies / Nickel
	Fastening Nut / Nickel
	Washer / Nickel

1. CRIMP FERRULE
HEX. CRIMP TOOL SIZE: 3.25 [.128]

Recommended Mounting Hole

NOTES:

- ALL SPECIFICATIONS ARE SUBJECT TO CHANGE WITHOUT NOTICE AT ANY TIME
- CUSTOMER OUTLINE DRAWING FOR REFERENCE ONLY

DRAWN: L. Ma 03/14/09
ENGINEER: J. Zhu 03/14/09
APPROVED: M. Dong 03/14/09
TOLERANCE UNLESS OTHERWISE SPECIFIED
X ±0.50 [.019"]
.X ±0.20 [.008"]
.XX ±0.10 [.004"]
ANGLES ±1°

TITLE:

RP SMA Straight Bulkhead
Female Crimp for
LMR100/RG174/RG316 Cable

PART No.: 61-02-1B00-001

CMPPTER®

www.cmppter.com



DIMENSIONS IN MILLIMETERS (mm)

SIZE:
A4

SCALE:
4:1

SHEET:
1/1

REV:
B