

# TECHNICAL DATA

## Electrical

Impedance	50 Ω
Frequency range	0~6 GHz
Withstanding voltage	1000 V
Insulation resistance	≥5x10 <sup>3</sup> MΩ

## Mechanical & Environmental

Durability (matings)	>500
Temperature range	-55 °C ~ +165 °C
RoHS Compliant	Yes

## Material & Finish

Body	Brass, See Table
Pin Contact	Beryllium Copper Alloy, Gold-plated
Fastening Nut	Brass, See Table
Washer	Beryllium Copper Alloy, See Table
Crimp Ferrule	Copper, Nickel-plated
Insulator	PTFE

## Interface Standards

SMA	IEC-60169
-----	-----------

REVISIONS				
REV	DESCRIPTION OF REVISION	ECN No.	DATE	APPROVED
A	INITIAL RELEASE	---	04/21/2007	M. Dong
B	STRUCTURE CHANGED	---	11/18/2016	M. Dong

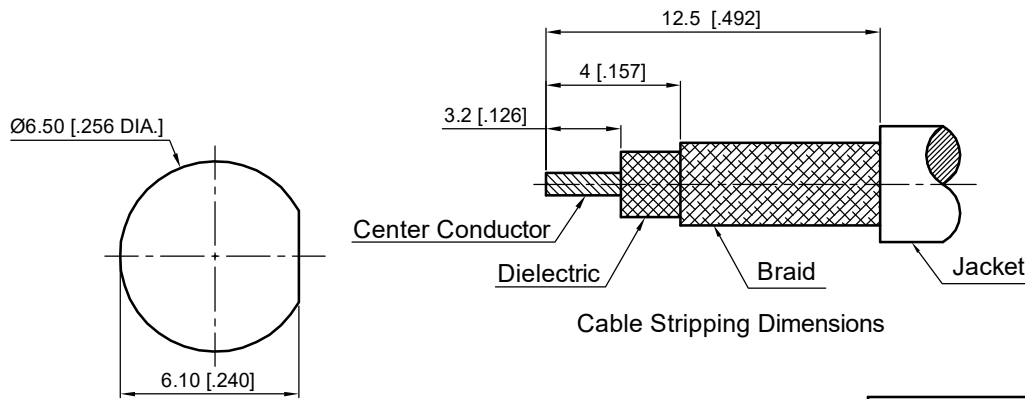
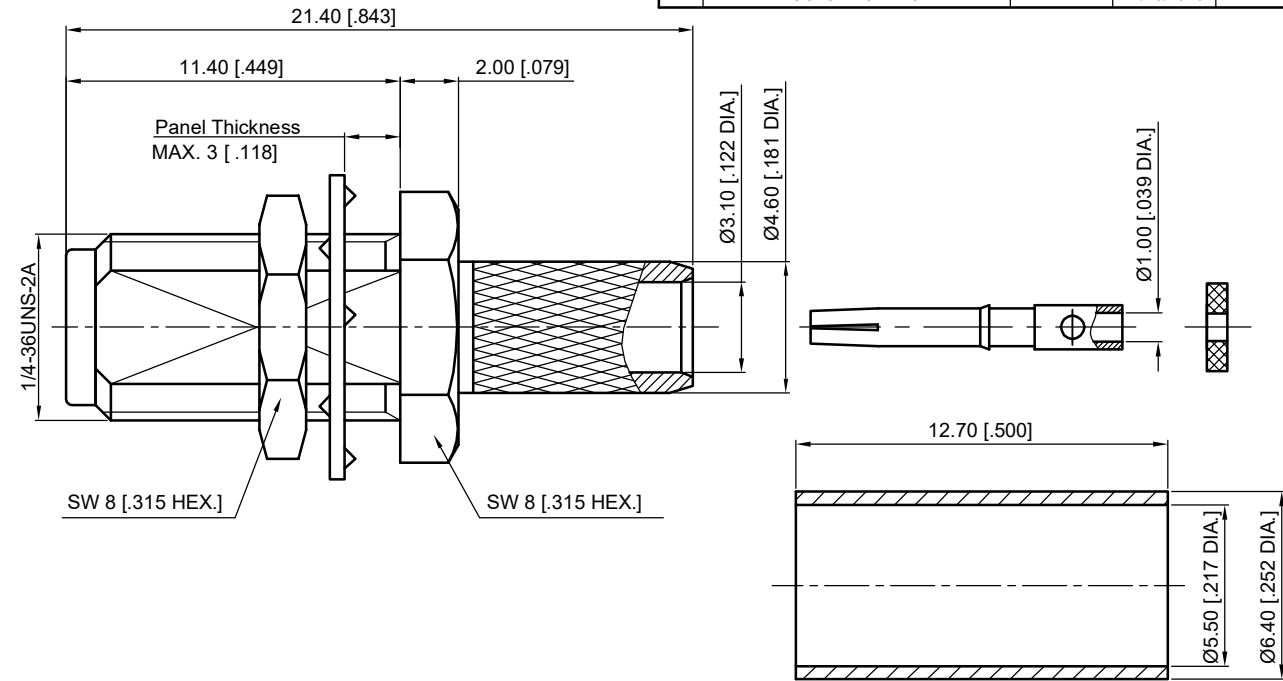

Part Number	Part / Finish
60-02-1B18-021-1	Bodies / Gold
	Fastening Nut / Gold
	Washer / Gold
60-02-1B18-021-2	Bodies / Nickel
	Fastening Nut / Nickel
	Washer / Nickel

1. CRIMP FERRULE  
HEX. CRIMP TOOL SIZE: 5.4 [.213]

### Recommended Mounting Hole

- NOTES:
- ALL SPECIFICATIONS ARE SUBJECT TO CHANGE WITHOUT NOTICE AT ANY TIME
  - UNLESS OTHERWISE SPECIFIED ALL DIMENSIONS ARE NOMINAL.

UNLESS OTHERWISE SPECIFIED, DIMENSIONS ARE IN MILLIMETERS (INCHES).  
UNLESS OTHERWISE SPECIFIED DIMENSIONAL TOLERANCES ARE:  
.XX ±0.13 [.005"]  
.X ±0.20 [.008"]  
X ±0.50 [.019"]  
ANGULAR TOLERANCES ARE: ALL= ±1°  
DO NOT SCALE DRAWING  
PROJECTION:

DRAWN:	L. Ma	11/18/2016
CHECKED:	J. Zhu	11/18/2016
APPROVED:	M. Dong	11/18/2016
TITLE: SMA Straight Bulkhead Female Crimp for RG58/LMR195 Cable		

**CMPPTER**<sup>®</sup>  
Cmppter Electronics Co., Ltd. [www.cmppter.com](http://www.cmppter.com)

PART No.:  
**60-02-1B18-021**

SIZE: A4	SCALE: 4:1	SHEET: 1/1	REV: B
-------------	---------------	---------------	-----------