

TECHNICAL DATA

Electrical

Impedance 50 Ω
 Frequency range 0~6 GHz
 Withstanding voltage 500 V
 Insulation resistance ≥5000MΩ

Mechanical & Environmental

Durability (matings) >500
 Temperature range -55 °C ~ +165 °C
 RoHS Compliant Yes

Material & Finish

Body Brass, Gold-plated
 Pin Contact Beryllium Copper Alloy, Gold-plated
 Crimp Ferrule Copper, Nickel-plated
 Insulator PTFE

Interface Standards

SMA IEC-60169

REVISIONS				
REV	DESCRIPTION OF REVISION	ECN No.	DATE	APPROVED
A	INITIAL RELEASE	---	07/13/2012	M. Dong
B	DIMENSIONS CHANGED	---	06/30/2014	M. Dong
C	DIMENSIONS CHANGED	---	10/15/2014	M. Dong

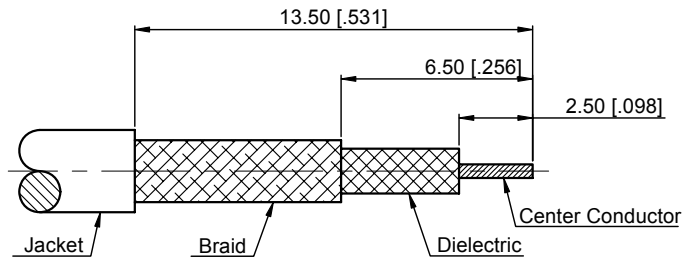
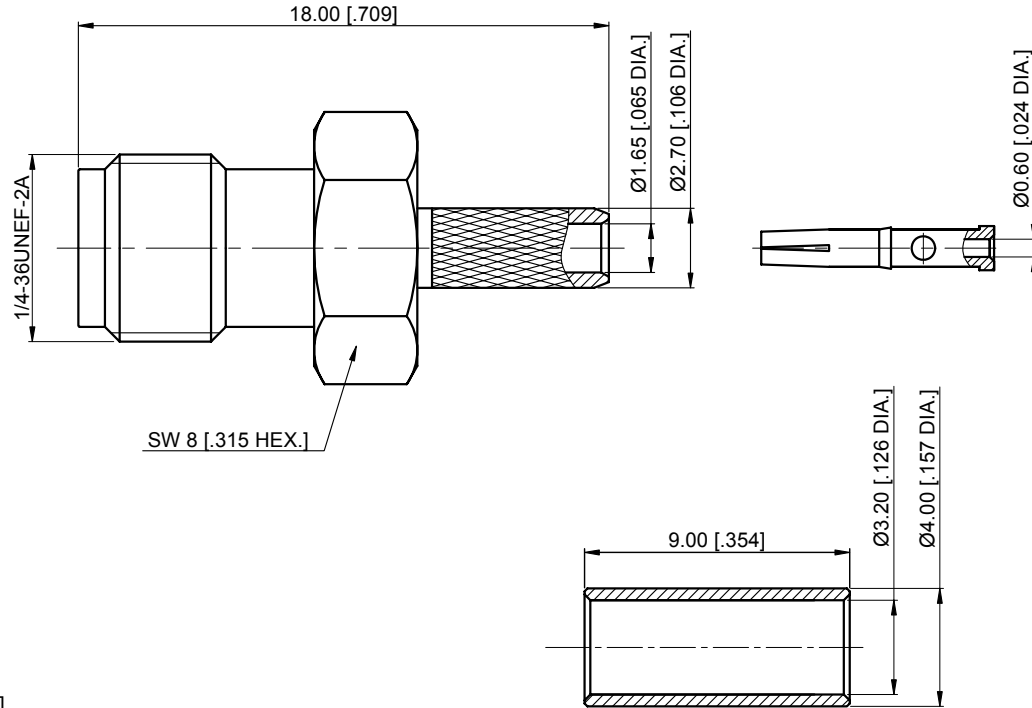

Recommended Cable Stripping Dimensions

1. CRIMP FERRULE
 HEX. CRIMP TOOL SIZE: 3.25 [.128]

NOTES:

- ALL SPECIFICATIONS ARE SUBJECT TO CHANGE WITHOUT NOTICE AT ANY TIME
- UNLESS OTHERWISE SPECIFIED ALL DIMENSIONS ARE NOMINAL.

UNLESS OTHERWISE SPECIFIED, DIMENSIONS ARE IN MILLIMETERS [INCHES]. UNLESS OTHERWISE SPECIFIED DIMENSIONAL TOLERANCES ARE: XX ±0.13 [.005" X ±0.20 [.008" X ±0.50 [.019" ANGULAR TOLERANCES ARE: ALL ±1° DO NOT SCALE DRAWING PROJECTION:	
---	--

DRAWN:	L. Ma	10/15/2014
CHECKED:	J. Zhu	10/15/2014
APPROVED:	M. Dong	10/15/2014

TITLE:
**SMA Straight Female Crimp
 for LMR100/RG174/RG316
 Cable**

Cmppter Electronics Co., Ltd. www.cmppter.com			
PART No.: 60-02-1M00-150			
SIZE: A4	SCALE: 4:1	SHEET: 1/1	REV: C