

# TECHNICAL DATA

## Electrical

Impedance	50 Ω
Frequency range	0~18 GHz
Withstanding voltage	500 V
Insulation resistance	≥5000MΩ

## Mechanical & Environmental

Durability (matings)	>500
Temperature range	-55 °C ~ +165 °C
RoHS Compliant	Yes

## Material & Finish

Body	Brass, Gold-plated
Pin Contact	Beryllium Copper Alloy, Gold-plated
Insulator	PTFE

## Interface Standards

SMA	IEC-60169
-----	-----------

REVISIONS				
REV	DESCRIPTION OF REVISION	ECN No.	DATE	APPROVED
A	INITIAL RELEASE	—	03/14/2019	M. Dong

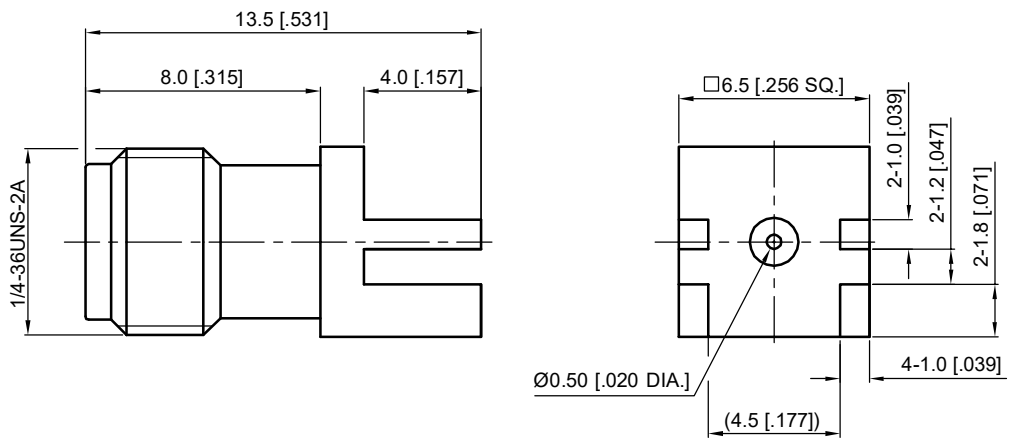

- NOTES:
- ALL SPECIFICATIONS ARE SUBJECT TO CHANGE WITHOUT NOTICE AT ANY TIME
  - UNLESS OTHERWISE SPECIFIED ALL DIMENSIONS ARE NOMINAL.

UNLESS OTHERWISE SPECIFIED, DIMENSIONS ARE IN MILLIMETERS [INCHES]. UNLESS OTHERWISE SPECIFIED DIMENSIONAL TOLERANCES ARE:	
.XX	±0.13 [0.005"]
.X	±0.20 [0.008"]
X	±0.50 [0.019"]
ANGULAR TOLERANCES ARE: ALL= ±1°	
DO NOT SCALE DRAWING	
PROJECTION:	

DRAWN:	L. Ma	03/14/2019
CHECKED:	J. Zhu	03/14/2019
APPROVED:	M. Dong	03/14/2019

TITLE:  
**SMA Straight Female for PCB Board, Edge Mount**

Cmppter Electronics Co., Ltd. <a href="http://www.cmppter.com">www.cmppter.com</a>			
PART No.: <b>60-02-5L2-332</b>			
SIZE: A4	SCALE: 4:1	SHEET: 1/1	REV: A