

TECHNICAL DATA

Electrical

Impedance	50 Ω
Frequency range	0~18 GHz
Withstanding voltage	1000 V
Insulation resistance	≥5000MΩ

Mechanical & Environmental

Durability (matings)	>500
Temperature range	-55 °C ~ +165 °C
RoHS Compliant	Yes

Material & Finish

Body	Brass, Gold-plated
Pin Contact	Brass, Gold-plated
Coupling Nut	Brass, Gold-plated
Gasket	Silicone Rubber
Insulator	PTFE

Interface Standards

SMA	IEC-60169
-----	-----------

REVISIONS				
REV	DESCRIPTION OF REVISION	ECN No.	DATE	APPROVED
A	INITIAL RELEASE	---	08/12/2007	M. Dong
B	ADD SOLDERING DIMENSION	---	06/01/2011	M. Dong
C	STRUCTURE CHANGED	---	03/28/2016	M. Dong

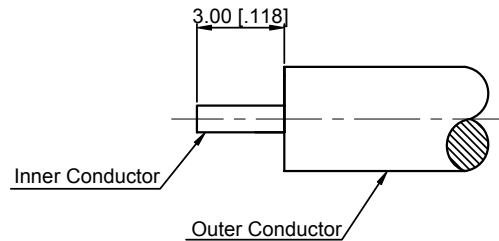
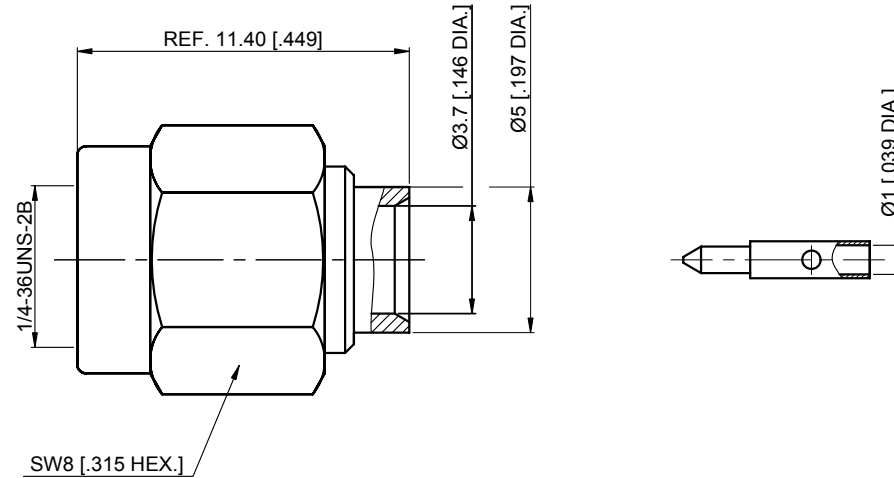

CABLE STRIPPING DIMENSION

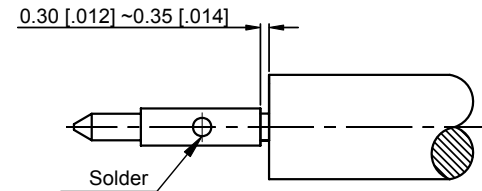

PIN CONTACT SOLDERING DIMENSION

NOTES:

- ALL SPECIFICATIONS ARE SUBJECT TO CHANGE WITHOUT NOTICE AT ANY TIME
- UNLESS OTHERWISE SPECIFIED ALL DIMENSIONS ARE NOMINAL.

UNLESS OTHERWISE SPECIFIED, DIMENSIONS ARE IN MILLIMETERS [INCHES]. UNLESS OTHERWISE SPECIFIED DIMENSIONAL TOLERANCES ARE: .XX ±0.13 [.005"] .X ±0.20 [.008"] X ±0.50 [.019"]	
ANGULAR TOLERANCES ARE: ALL±1°	
DO NOT SCALE DRAWING	
PROJECTION:	

DRAWN:	L. Ma	03/28/2016
CHECKED:	J. Zhu	03/28/2016
APPROVED:	M. Dong	03/28/2016

TITLE:
**SMA Straight Male Solder for
RG402/.141 Cable**

CMPTEER®
Cmpteer Electronics Co., Ltd. www.cmpteer.com

PART No.:
60-03-2M06-001

SIZE: A4	SCALE: 4:1	SHEET: 1/1	REV: C
-------------	---------------	---------------	-----------